

Contents

General Maintenance	P.1
Decimal Point Selector Switch	P.2
Rounding Switch	P.2
Identifying Printouts	P.2
Using the Memory	P.2
Percentage Memory Calculations	P.3
Item / Memory Item Counting	P.4
Replacing The Ink Roller	P.5
Inserting Printing Paper	P.5
Calculation Example	P.56-64

General Maintenance

- 1) Do not use or leave the calculator under direct sunlight. Press subject to rapid temperature changes, high humidity, dust and dirt should also be avoided.
- 2) Use a dry cloth to clean the casing of the unit. Do not use water or detergents.
- 3) Only use the printer when the paper roll is loaded.
- 4) Avoid using the calculator in places where there are iron filings, as this may affect the electrical circuits of the calculator.
- 5) Do not place anything on top of the machine, particularly on top of the printer mechanism.
- 6) Turn the calculator off before removing the plug from the electrical outlet.
- 7) In case of electrical fault (i.e. smoke), disconnect the plug from the electrical point immediately. Keep obstacles away from the point so you can disconnect the plug at any time.
- 8) The socket outlet should be near to the equipment and easily accessible.

1

Item / Memory Item Counting

Item Count Switch



At "n+" position, the switch allows you to total all items including both positive and negative data in addition and subtraction calculation. In this case, the number of times the (+) and (-) keys have been pressed will be counted.

At "n+/-" position, the switch totals the items of positive data only in addition calculations. Accordingly, in this case the number of times the (+) key is used.

Press the (Σ) key for printout of the sub-total of the item count, and the (Σ) key for printout of the grand total. If you add the wrong number, you can easily correct it without affecting the item count total. Simply press the (C) key. Neither the wrong number of it will be included in the item.

Memory Item Counting

This function automatically counts the items in addition and subtraction calculations using the memory. Press the (M+) key to print a sub-total of the item count, and the (M+) key to print the grand total.

Using the memory, the calculation results and the item count are automatically cleared by pressing the (C) key.

Overflow Function

In the following cases, "E" is displayed, the keyboard is electronically locked, and further operation is impossible. Press (C) to clear the overflow. The overflow function occurs when:

1. The result or the memory content exceeds 10 digits (P29-DIII) or 12 digits (P39-DIII) to the left of the decimal point.
 2. Dividing by "0".
 3. The sequential operation speed is faster than the calculation processing speed. (Buffer Register Overflow)
- Electromagnetic interference or electrostatic discharge may cause either the display or the printer to malfunction, a printer error lock, or the contents of the memory to be lost or altered. Should this occur, press the (C) key or turn the power slide switch off and then turn it on again to restart the calculation from the beginning.

4

Decimal Point Selector Switch



: Used for designating the decimal point position (0 1 2 3) for calculated results.



+ (Add-Mode) : Addition and subtraction functions are performed with an automatic 2-digit decimal. It is convenient for currency calculations.



F (Floating Decimal Point) : All effective numbers up to 10 digits (P29-DIII) or 12 digits (P39-DIII) are printed or displayed.

Rounding Switch



: For rounding a final result of multiplication or division to a preselected number of decimal digits. Left position for round-off [5/4], and right position for round-down [↓].

Identifying Printouts

Used in the following cases:

- 1) Non-add function (#)

To print out figures which do not affect the calculation such as dates and serial numbers. Figures are printed on the left-hand side of the paper. Used for printing dates, code numbers and voucher numbers, etc.
- 2) Subtotal (◁) or Total Reprint (#) function

To print out an intermediate result (subtotal function). To reprint a calculation result on the left-hand side of the paper for easy reference (total reprint function).

Using the Memory

Accumulating/Storing numbers in the memory

How to accumulate/store numbers that are displayed:

The entered number or the calculation result will be accumulated in the memory by pressing the (M+) or (M-) key. (M-) key reverse the sign of a number from "+" to "-" or from "-" to "+" before accumulating it in the memory. When the (M+) switch is set at AM position, entered number will be automatically accumulated in the memory register by pressing the (M+) key.

2

Specifications

Operation Temperature: 0°C to 40°C (32°F to 104°F)
 Dimension: 200 mm (W) x 250 mm (L) x 65 mm (H) /
 7-7/8" (W) x 9-27/32" (L) x 2-9/16" (H)
 Weight: 1.2 kg (2 lb 10 oz)
 Power source: AC 115 V 50/60 Hz 4.3 W
 AC 230 V 50 Hz 0.07 A
 AC 240 V 50/60 Hz 0.07 A
 (Subject to change without notice)

Replacing The Ink Roller

Be sure to turn the power switch off when replacing the ink roller.

- 1) Remove the printer cover by pushing down on the ▲ mark. (Figure 1)
- 2) Lift up the old ink roller handle and remove it. (Figure 2)
- 3) Insert the new ink roller. (Figure 3) For the Canon P29-DIII/P39-DIII please use Canon Ink Roller CP-7.
- 4) Replace the printer cover and pull out the edge of the paper from the printer cover. (Figure 4)

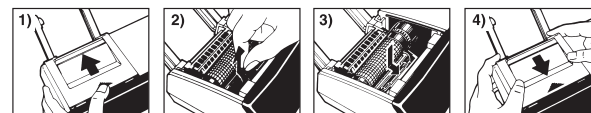

Inserting Printing Paper

- 1) Install the paper holders by lowering them so that their hooks fit firmly onto the rear housing of the calculator. (Figure 5)
- 2) Put the new paper roll in the paper holder, slightly opening the paper holders in the ← direction as indicated in Figure 6. The edge of the paper should be directed as shown by the arrow.
- 3) Insert the edge of the paper firmly into the slot behind the arrow. (Figure 7)
- 4) Press the (PAPER FEED) key to advance the paper. (Figure 8)

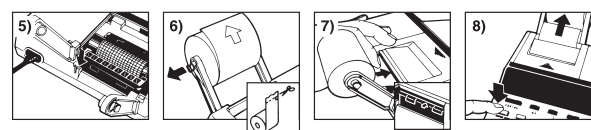

5

How to accumulate/store numbers automatically as the result is being obtained:

On completion of calculation, instead of pressing the (Σ), press the (M+) or (M-) key to automatically accumulate/store the results in the memory register. When the (M+) key is pressed, the "+" sign of a positive number accumulated/stored in the memory is changed to "-" and a negative sign to "+". When the (M-) switch is set at AM position, calculated results will be automatically accumulated in the memory register by pressing the (Σ) key.

Recalling and Clearing the Memory

The intermediate results in the memory can be recalled with the (M+) or (M-) key. When the (M-) key is pressed, the memory will be printed and at the same time the memory contents will be cleared. The (M-) key will not clear the memory contents.

Percentage Memory Calculations

To perform mark-up or mark-down calculations:

Set the (M+) switch to MU. Then, enter the percentage of mark-up or mark-down expressed as a whole number. If you want to compute mark-up, press (M+), or if you want to compute mark-down, press (M-). After entering the price you want to compute, press (Σ). The calculator automatically computes the new price based on the amount of mark-up or mark-down you entered. Press (M+) key to clear memory contents before entering the percentage of mark-up or mark-down.

To add or subtract a percentage from an addition or subtraction result:

Set the (M+) switch to %± then, enter the percentage you want to subtract or add expressed as a whole number. If you want to add the percentage to the result press (M+), or if you want to subtract the percentage from the result, press (M-). After entering the numbers you want to compute, press (Σ). The calculator automatically adds or subtracts from the result the percentage you entered. Press (M+) key to clear memory contents before entering the percentage you want to subtract or add.

3